

# Diesel Engine 10V 1600

for Oil and Gas Applications  
with EPA Tier 4 Certification

Preliminary  
data

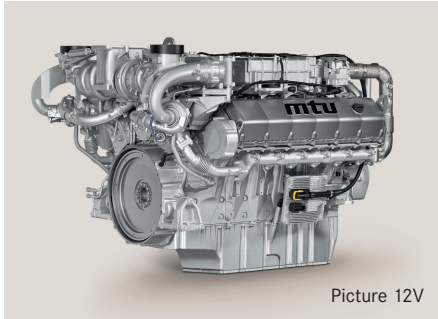

Picture 12V

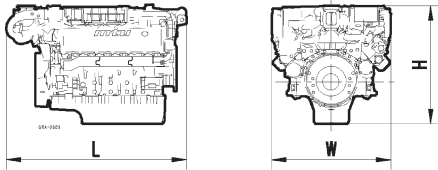

### Dimensions and Masses

Engine	Dimensions (LxWxH) mm (in)	Mass, dry kg (lbs)
10V 1600 C	1700x1200x1200 (66.9x47.2x47.2)	1940 (4277) <sup>1)</sup>

All dimensions are approximate, for complete information refer to the installation drawing.  
<sup>1)</sup> DIN 70020

Engine Model		
Bore/stroke	mm (in)	122/150 (4.8/5.9)
Cylinder configuration		10 V
Displacement	l (cu in)	1.75 (107)
Displacement, total	l (cu in)	17.5 (1077)
Fuel specification		DIN EN 590, ASTM D975 (DF1, DF2)

Engine Type	Rated Power			Peak Torque			Fuel Consumption at rated power	Fuel Consumption at peak torque
	Model	kW	bhp	rpm	Nm	lb-ft	rpm	g/kWh
10V 1600 C60	567	760	1900/2100	3340	2460	1300	206	198
10V 1600 C70	610	817	1900/2100	3500	2580	1600	206	198

Emissions: EPA 40 CFR 89 / Tier 4 final

**Available from January 2015**  
Also available for non regulated markets. For information please contact your MTU distributor.



Power. Passion. Partnership.

## Standard Equipment

Common rail injection system
Electronic engine management
Two stage turbo charging with low temperature charge air cooling circuits
2nd coolant water pump for low temperature charge air cooling circuit
High pressure EGR system with high temperature cooling circuit
Engine mounted charge air and EGR coolers
24 Volt starter
28 Volt alternator, 80 A
SAE 1 flywheel housing
Mounting brackets
Close crankcase ventilation

### Reference conditions:

> Intake temperature: 25°C (77°F)

> Charge air temperature at 50°C coolant temp.: 45°C

> Ambient air pressure: 1000 mbar

> Altitude above sea level: 100 m (328 ft)

Subject to change without notice. Customization possible. Engines illustrated in this document may feature options not fitted as standard to standard engine.

## Optional Equipment

24 Volt alternator, 55 - 200 A
Exhaust brake system
Fuel prefilter
PTO drives for hydrostatic pumps (SAE A and SAE B)
AC compressor
Coupling for main PTO
Resilient engine mountings
Air compressor
Elevated fan drive
Cooling fan